

Transforming
everyday spaces
through innovation
and design.



Facades



Skylights



Outdoor



Panel Systems

COXWELL



From light to life.

At Coxwell, we believe architecture should do more than provide shelter — it should inspire. With over 30 years of experience, more than 2,755 satisfied clients, and over 5,200 projects delivered, we are proud to lead India's next generation of polycarbonate-based building solutions.

Our expertise spans daylighting systems, roofing, facades, and interior applications — offering products that combine performance, aesthetics, and innovation. Drawing inspiration from the rich tapestry of Indian and global architecture, we create solutions that bring light to life. From massive industrial skylights to bold architectural facades, Coxwell is the brand of choice for builders who want to create something exceptional.







Designed for daylight

Our polycarbonate solutions offer an impressive combination of lightweight design, high impact resistance and durability. Their reduced weight not only lowers transportation costs but also facilitates quick and easy installation. They provide excellent thermal insulation, UV protection, and flame resistance, ensuring long-term light transmission without condensation build-up.

Superior Performance, Maximum Impact

What gives our products an edge?



Aesthetic Designs

With a wide range of vibrant colors, our products seamlessly complement a variety of environments, adding a visually pleasing element to both indoor and outdoor settings.



Anti-glare

Engineered with a co-extruded matte finish, our panels eliminate sun glare, reducing eye strain and enhancing visual comfort, no matter the building or exposure.



UV Protection

Co-extruded UV protection on both sides prevents sun damage, preserving panel clarity and extending their lifespan even during the harshest weather conditions.



Anti-Static

The advanced treatment minimizes static buildup, reducing dust and keeping your space cleaner and more efficient.



Infrared Technology

Our panels absorb infrared rays (780-1400nm), blocking excess heat while allowing natural light. This keeps your interiors cooler and reduces energy costs.



LEED Certified

Our products are LEED-certified, ensuring they meet the highest standards for sustainability and environmental performance.



Innovative

Prism ^{New}

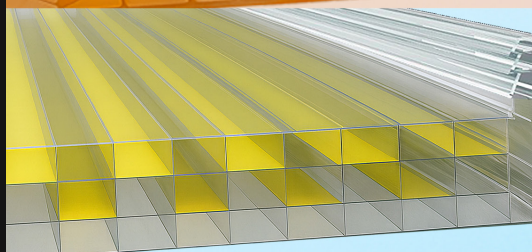

Vivid ^{New}

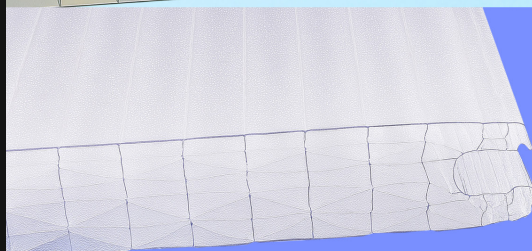

Snapwall ^{New}

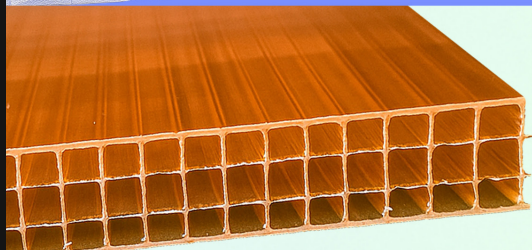

Multicell

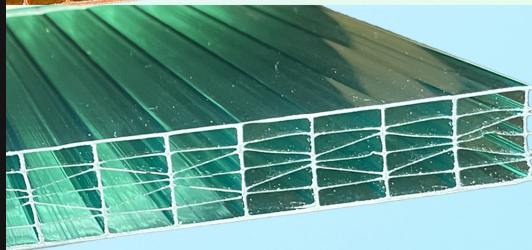

Xfix

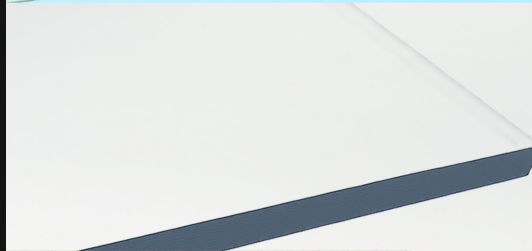

Traditional

Static

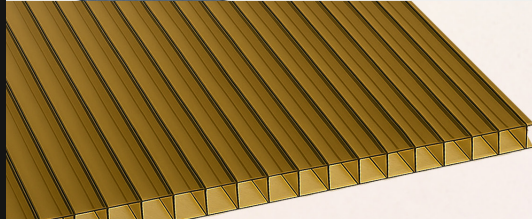

Spry

Our
range
of panels

Shades of White



Antiglare Shades of White



Vivid

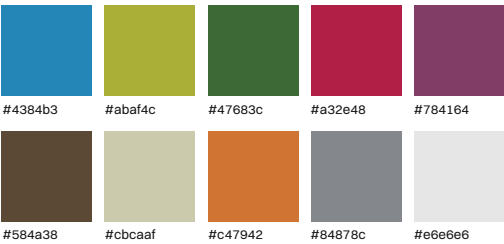

Extra Shading



Colorful Opaque

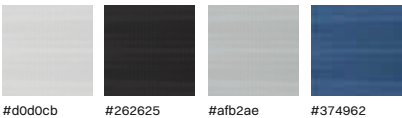

Metallic

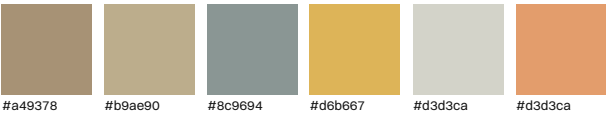

Soft Metallic



Colorful

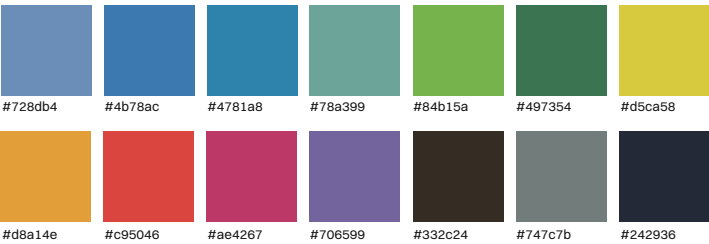

Antiglare Colorful

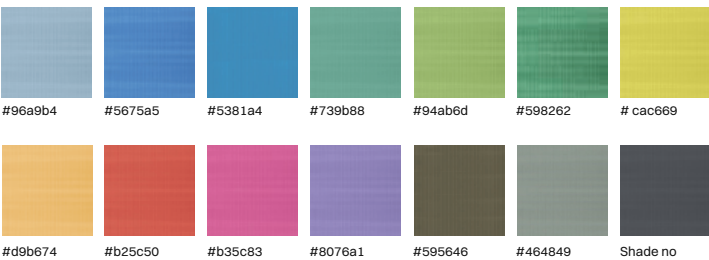

Bring your
space to life with
vibrant hues



Scan for more shades



What Makes Our Products Innovative?

Coxwell's Standing-Seam Interlocking Panels offer a smarter, more durable alternative to flat polycarbonate sheets.



Watertight by Design

Our panels lock over a continuous seam with no exposed screws or silicone joints, creating a fully sealed surface that resists leaks—even in heavy rain.

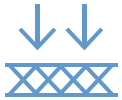

Superior Strength & Span

A seven-layer, multi-wall X-structure delivers high wind and snow resistance with better insulation, enabling wide spans without compromising energy performance.



Faster, Cleaner Installation

The click-and-fix seam snaps together in one motion, cutting install time by up to 30% and reducing labor costs.



Sleek, Seamless Finish

No visible fixings. Just a clean, continuous surface that elevates any architectural space—from retail stores to transit hubs.



Built-In Expansion Control

The interlocking design allows panels to expand and contract naturally with temperature changes, preventing cracks, warping and screw-hole damage.



Long-Term Value

With fewer maintenance needs, superior insulation, and a 10-year warranty, the panels offer lower lifecycle costs and long-lasting peace of mind.

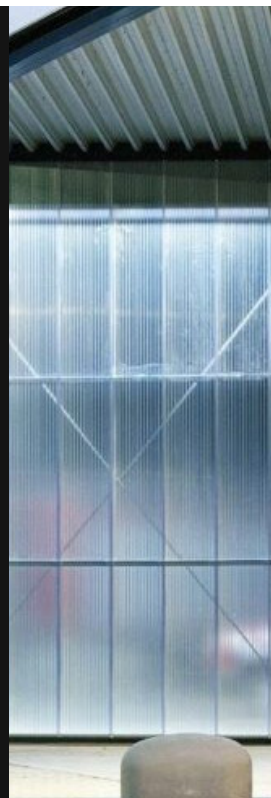
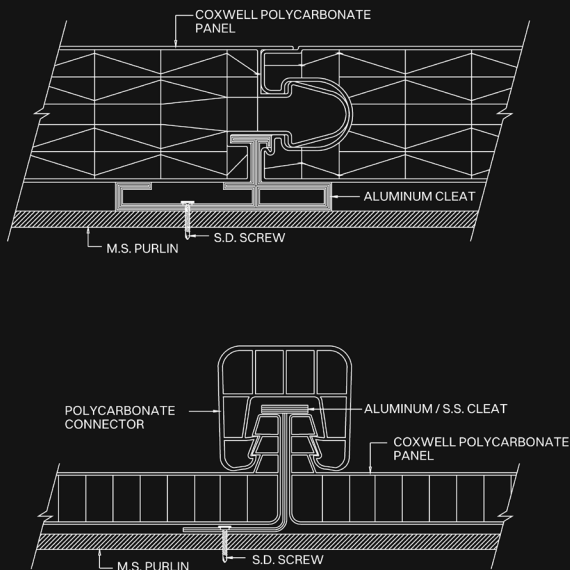



Turn Harsh Sunlight into Comfort

Prism elevates the way we experience light, color, and temperature within built environments. Integrated with an innovative Top Layer Climate Control Technology, this offers unmatched performance in balancing daylight, colour and thermal efficiency—creating a dynamic solution for year-round comfort. Built with a 6-layer prismatic design and vibrant dual/tri-colour fusion, they are the perfect fit for urban facades and projects that demand high resilience.

Coxwell Prism



Specifications

Thickness: 16-25mm

Width: 0.9 meters

Length: Up to 12 meters

Co-Extruded Colour Fusion

U-Value: 0.99 W/m²K

Certifications: ISO 9001 & 14001, ASTM G155



Coxwell Prism

Solar Screening for Climate Control™

Daylight where you want it,
insulation where you need
it, in a single panel

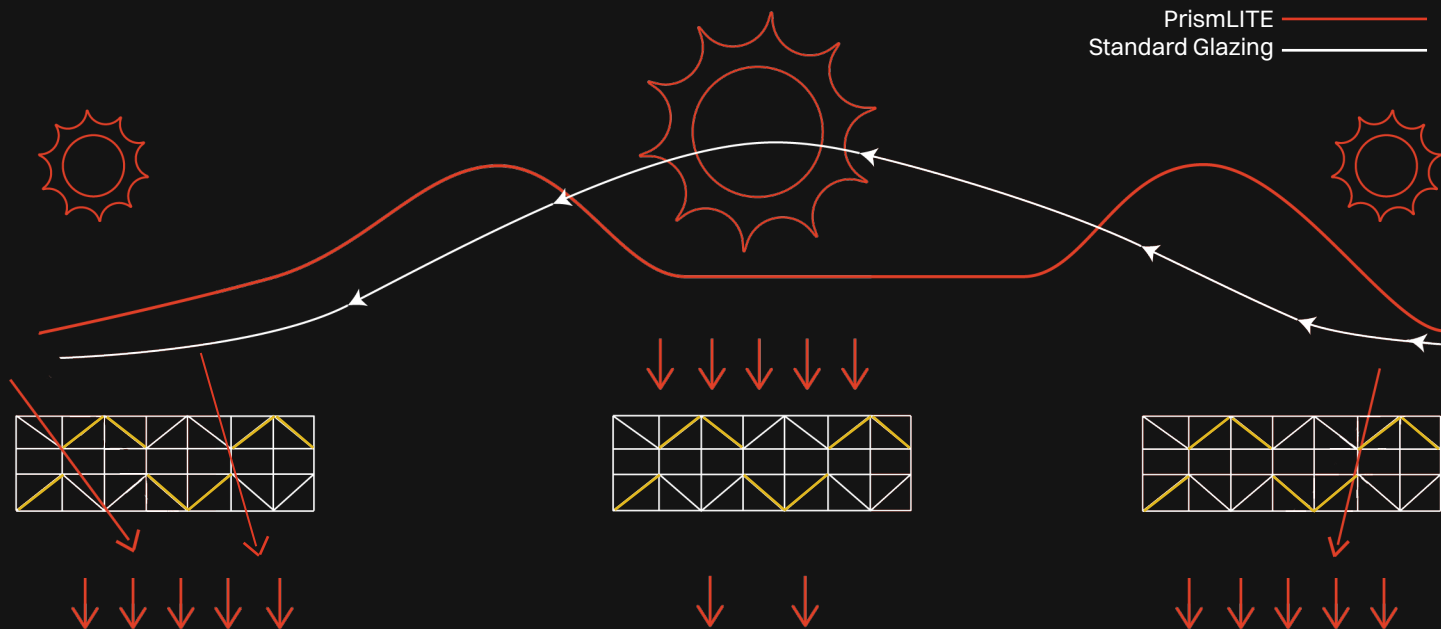

Morning

Micro-louvers inside the panel, channel sunlight deep into interiors when the sun is low, delivering bright, glare-free illumination.

Midday

At high sun angles, the louvers deflect excess solar gain, cutting peak heat load and reducing HVAC demand.

Evening

As the sun drops to a low angle, Prism's fixed micro-louvers tilt each ray, upward and deeper, flooding interiors with warmth and glow without the infrared heat keeping it cool till nightfall.

- Year round comfort with intelligent daylight with two proven daylight-management technologies into sheet
- Save upto 30% HVAC energy with dynamic heat screening
- Balanced daylight all day
- Glare free, clear and free of extra coatings
- Lightweight, virtually unbreakable polycarbonate with a 10-year colour-fast warranty

Summer Vs Winter

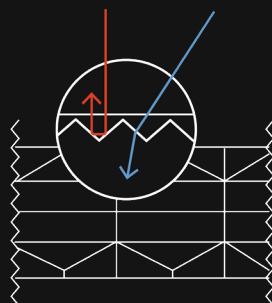

Summer —
Winter —

A prismatic top layer reflects most summer heat while allowing valuable passive warmth through in winter—keeping interiors cooler when it's hot and warmer when it's cold.

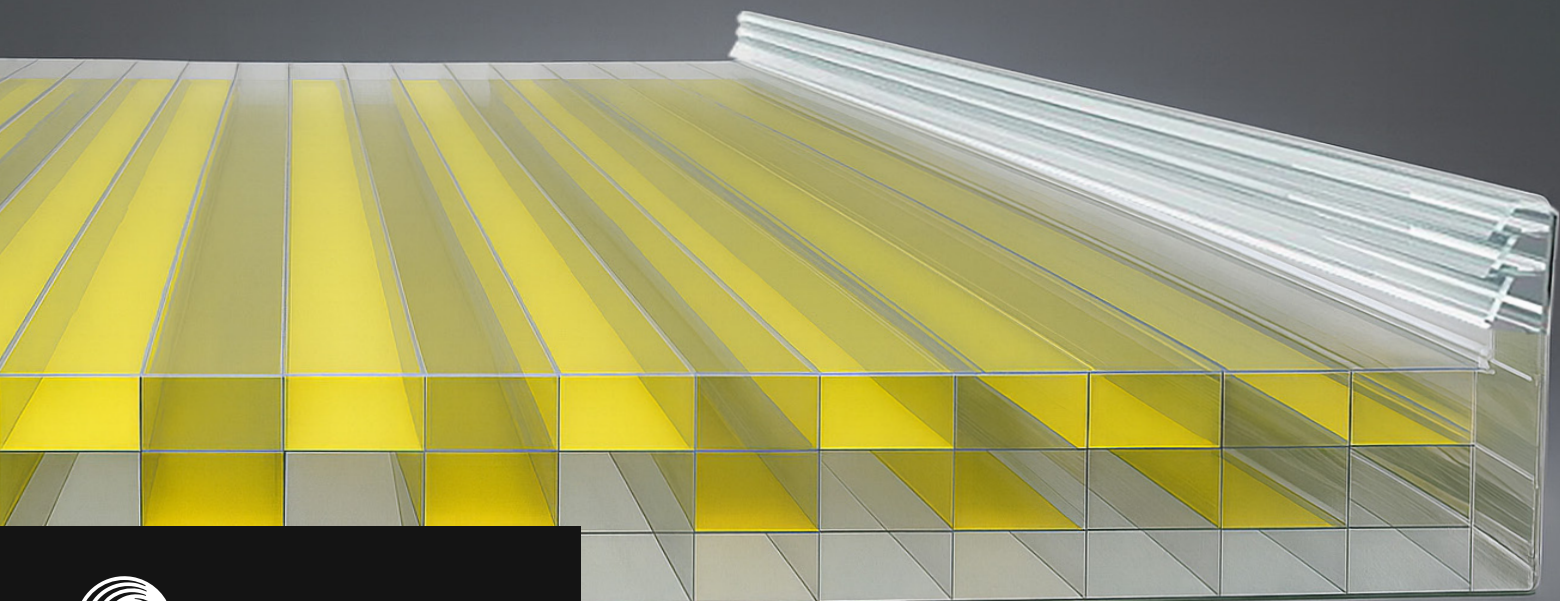

Where Colour, Comfort & Design Meet

Designed with a revolutionary 4-layer colour fusion, Vivid is best suited for high-end facades and roofs. Featuring Tertiary Colour Fusion Technology, this system integrates three colours in one panel and has high thermal performance with exceptional light diffusion properties - making them the perfect fit for projects that require dynamic visuals with smart environmental control.

Coxwell Vivid



Advantages



Solar Screening for
Heat Control



Easy Snap-On
Assembly



Three-Colour Fusion in
One Panel



100% Recyclable
Materials



High Weather
Resilience

Specifications

Thickness: 16-25mm

Width: 0.9 meters

Structure: 4-layer

Material: UV-protected polycarbonate

Light Transmission: Customized

U-Value: Based on colours & thickness

Daylight-Directional Louver Technology™

Harness the sun when you want it,
tame it when you don't.

- Precision-angled micro-louver matrix inside a 4-layer polycarbonate core
- Passive performance with zero maintenance
- Save upto 25% HVAC and lighting energy
- Visual drama without visual fatigue and glare free all day
- Balance daylight from dawn to dusk with thermal shield



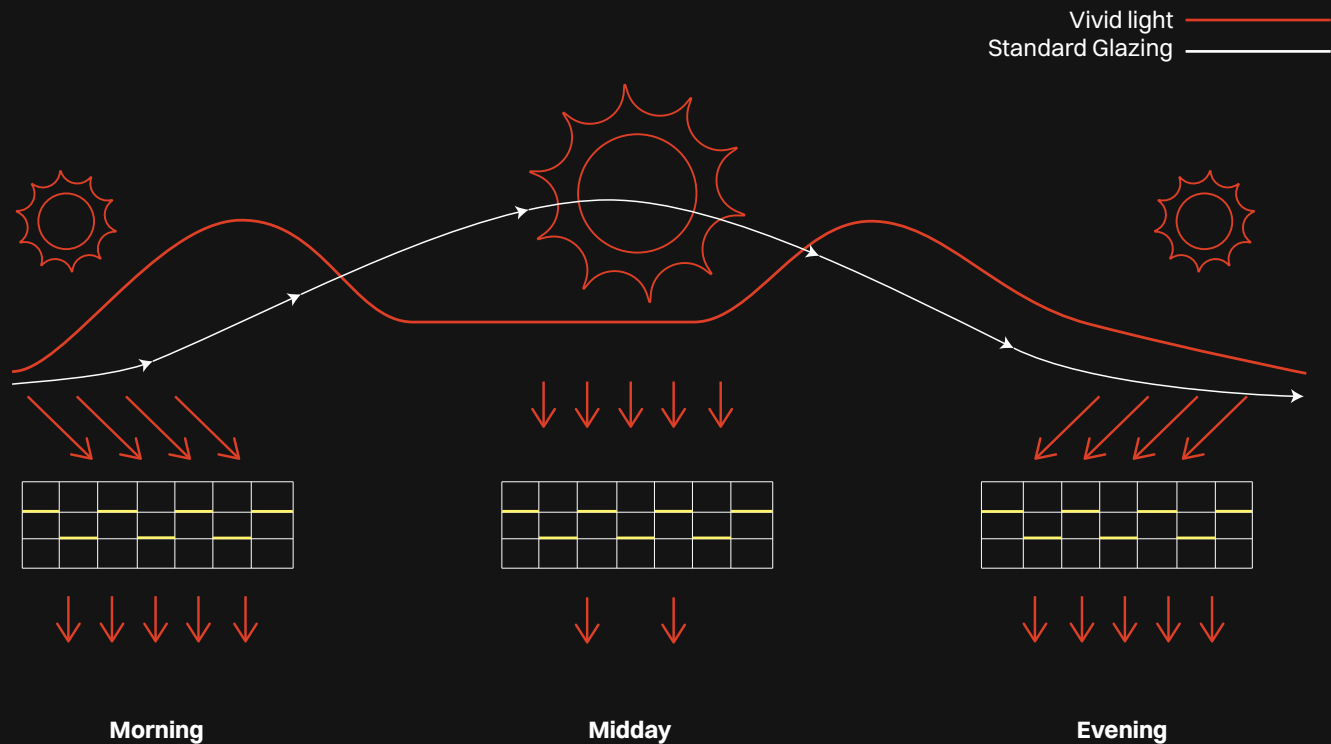

Sun Position	What Vivid Louvers Do	Result Inside the Building
Low angles (morning & late afternoon)	Louvers tilt light upward and inward, projecting bright daylight deep into the interior while scattering harsh direct beams.	Spaces feel naturally lit and welcoming without the glare that plagues east- or west-facing façades.
High angles (mid-day summer sun)	The same fixed louvers present a reflective face, bouncing up to 70 % of excess solar energy back out before it can convert to heat.	Peak cooling loads drop dramatically; occupants enjoy consistent thermal comfort.
Winter sun	Low winter rays pass through the open louver slots, delivering welcome passive warmth.	Energy demand for heating is reduced, improving year-round HVAC efficiency.



Revolutionary Click-Lock with Color Fusion

The first polycarbonate system with a 10-wall X-structure, Snapwall is perfect for structural strength without adding excessive weight. Designed for vertical applications, it features a Click-Lock system that enhances durability and faster installation, making them the ideal choice for vertical glazing and modern facades. Created with an eye for the future, this innovative system blends colour, strength and durability for stunning high-level facades.

Coxwell Snapwall

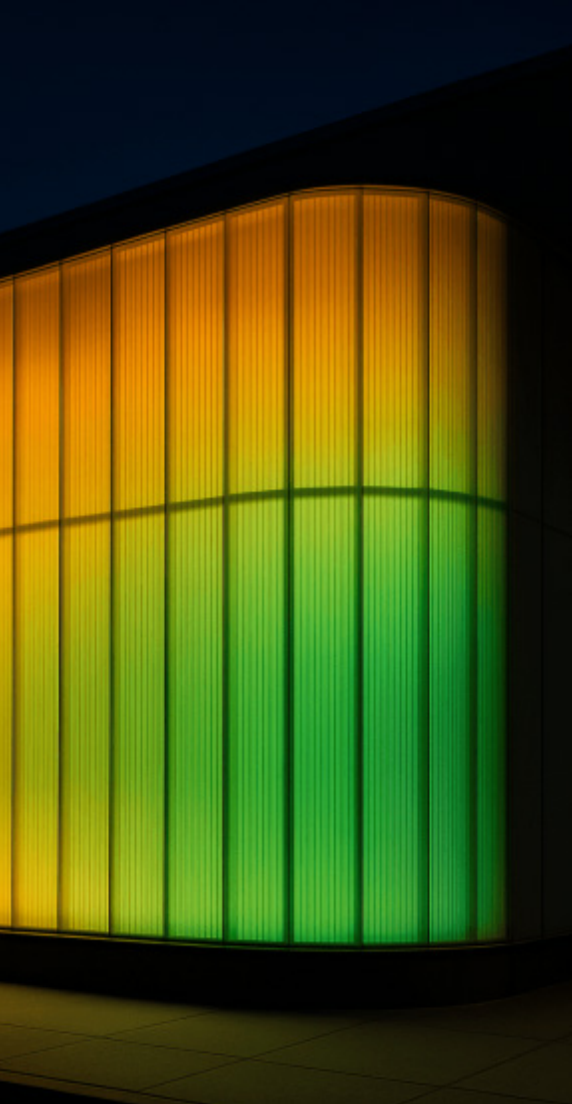

Advantages



10-layer Click-Lock
X-Structure



Rated Wind Load
Resistance



Three-Colour Fusion in
One Panel



Recyclable



Light Diffusion with
Zero Glare



Fire-Resistant

Specifications

Thickness: 40mm

Width: 500mm

Length: Up to 12 meters

Material: UV-protected polycarbonate

Light Transmission: Clear, Opal

U-Value: 0.99 W/m²K



Build lasting roofs, not maintenance bills

Designed with premium-grade polycarbonate, Multicell panels are made for durability and impact resistance. They offer a double-layer cellular structure with superior thermal insulation, light diffusion and long-term strength. Designed with Double Tooth interlocking, they ensure secure and leak-free installation. With a diverse portfolio of colours, Multi-cell panels can be engineered for diverse specifications at minimum costs.

Coxwell Multicell



Advantages



Natural Light +



Long-Span
Structural Strength



Thermal Insulation



Multiple Colors &
Finishes



Double Tooth
Interlocking System



Leak-Proof &
Weather Resistant

Specifications

Thickness: 6mm to 30mm

Width: 900mm

Length: Up to 11.8 meters

Material: UV-protected polycarbonate
3-cell (4-wall) and 5-cell (6-wall) options



The Smartest X-Structure You Can Afford

Crafted with a focus on superior strength and energy efficiency, X-Fix is suitable for commercial applications at accessible prices. With an advanced seven-layer & five-wall interlocking design, it offers maximum resistance with exceptional performance. Backed with a 10-year warranty, this offers excellent light transmission with the highest heat-blocking capabilities perfect for creating comfortable indoor environments regardless of external temperatures. X-fix is the best blend of lightweight design and durability, making them best suitable for industrial roofs, public buildings and commercial sheds.

Coxwell X-Fix

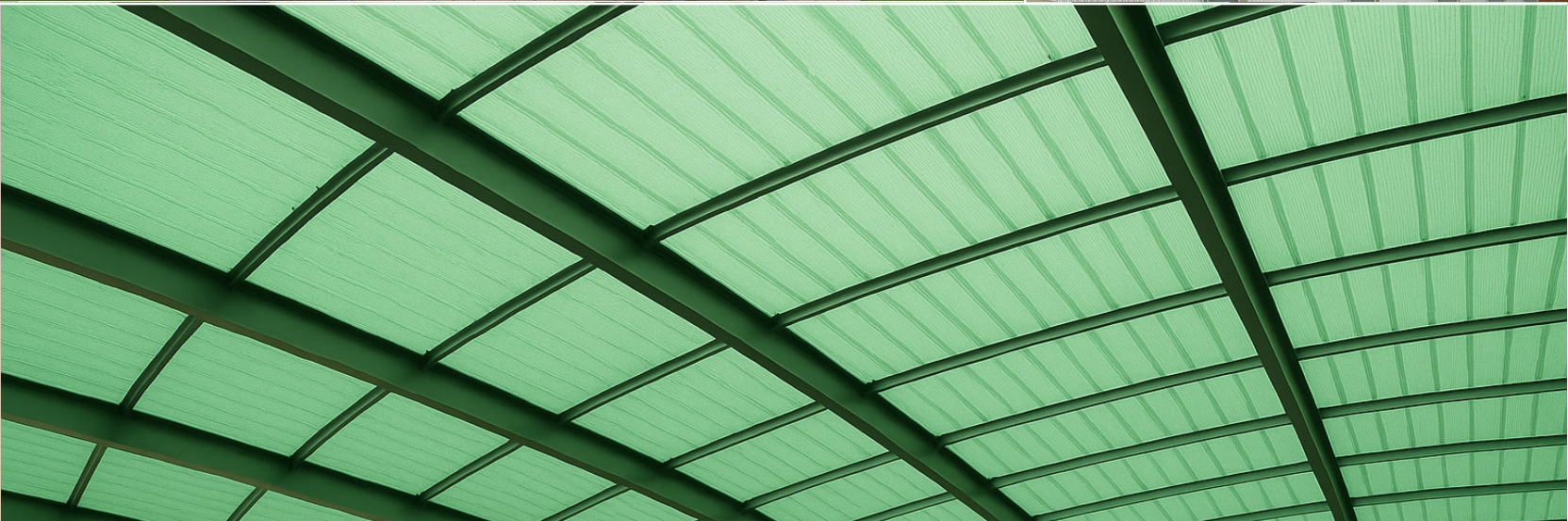

Advantages



Rigid X-Structure for
Load Capacity



Weather
Resistance



Cost-Efficient
Performance



Easy Dry-Fit
Installation

Specifications

Thickness: 16mm to 25mm

Width: 900mm

Length: Up to 12 meters

Fire-Retardant Versions Available

U-Value: Optimized based on thickness



For Clarity that Lasts. No Layers, Just Performance.

Designed with glass-like transparency, Static sheets systems are known for their high-impact resistance and 250x strength. With a smooth, flat finish, these sheets have up to 89% clarity along with UV protection on both sides, ensuring long-term performance without discolouration due to sun exposure. Made from a single layer of polycarbonate, the sheets provide superior strength and withstand a variety of temperatures, making them ideal for both indoor and outdoor applications, substituting for glass in facades, public buildings, carports, greenhouses and more.



Coxwell Static Sheet

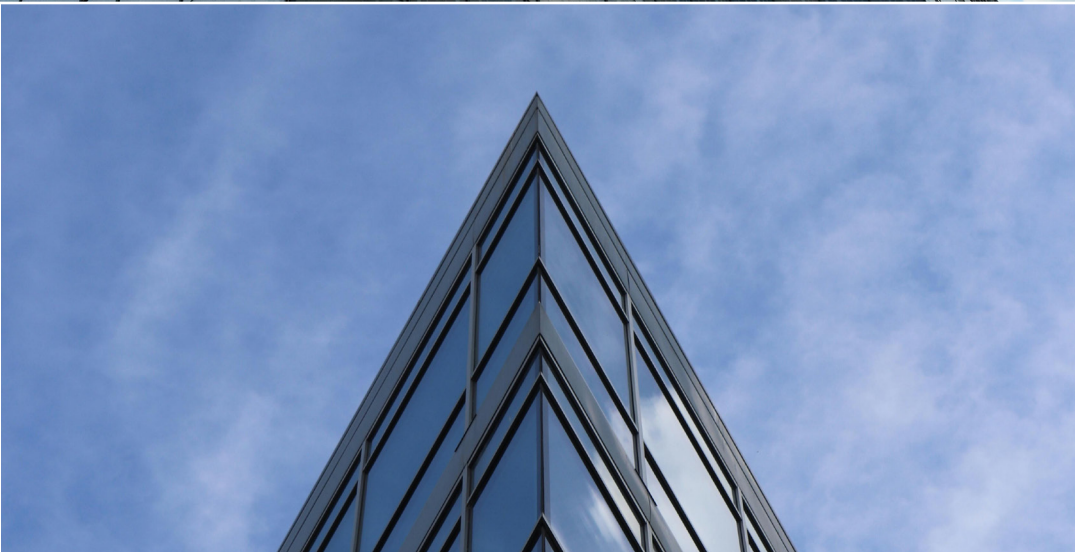

Advantages



High Optical
Clarity



UV-Protected for
Longevity



Tough and Impact
Resistant



Can be fabricated, bent,
or cut easily

Specifications

Thickness: 1.5mm to 12mm

Width: 1200mm and 2100mm

Finish Options: Clear, Opal, Bronze, Tints

Light Transmission: Up to 90%

Fire Rating: Available upon request



The sheet behind iconic builds

Engineered for toughness, transparency and UV protection, Multiwall System is a time-tested solution known for versatile performance and everyday reliability. Designed for preserving energy, these sheets are unbreakable and highly impact-resistant surpassing glass in strength. They can withstand harsh weather conditions, help in reducing heat loss in colder climates and limit heat gain during hotter seasons. With their Twin-wall structure and light-diffusing design, they offer clarity without glare, insulation without weight, and strength without compromise.



Coxwell
Spry



Advantages



High Light
Transmission



UV & Weather
Resistance



Lightweight
Yet Durable



Easy
Installations



Thermal
Efficiency



Fire Safety
Variants

Specifications

Thickness: 6mm to 12mm

Configuration: Twin-wall

Width: 1200mm and 2100mm

Length: Up to 11.8 meters

Material: UV-protected polycarbonate

Finishes: Clear, Opal White, Blue Tint,
Bronze Tint



Coxwell Creations

Through well-thought design and top-notch quality, our solutions are made to maximize natural daylight in every environment.

Because when daylight flows freely, creativity flourishes and communities thrive. That is the world we strive to create.

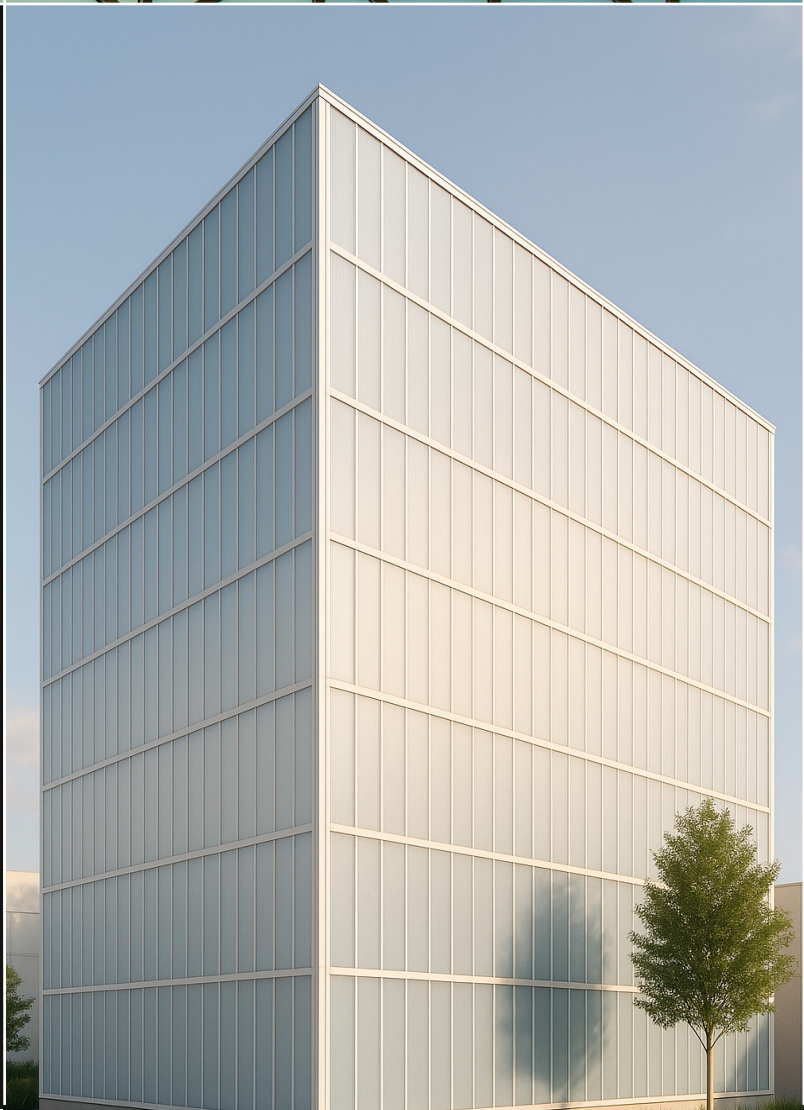

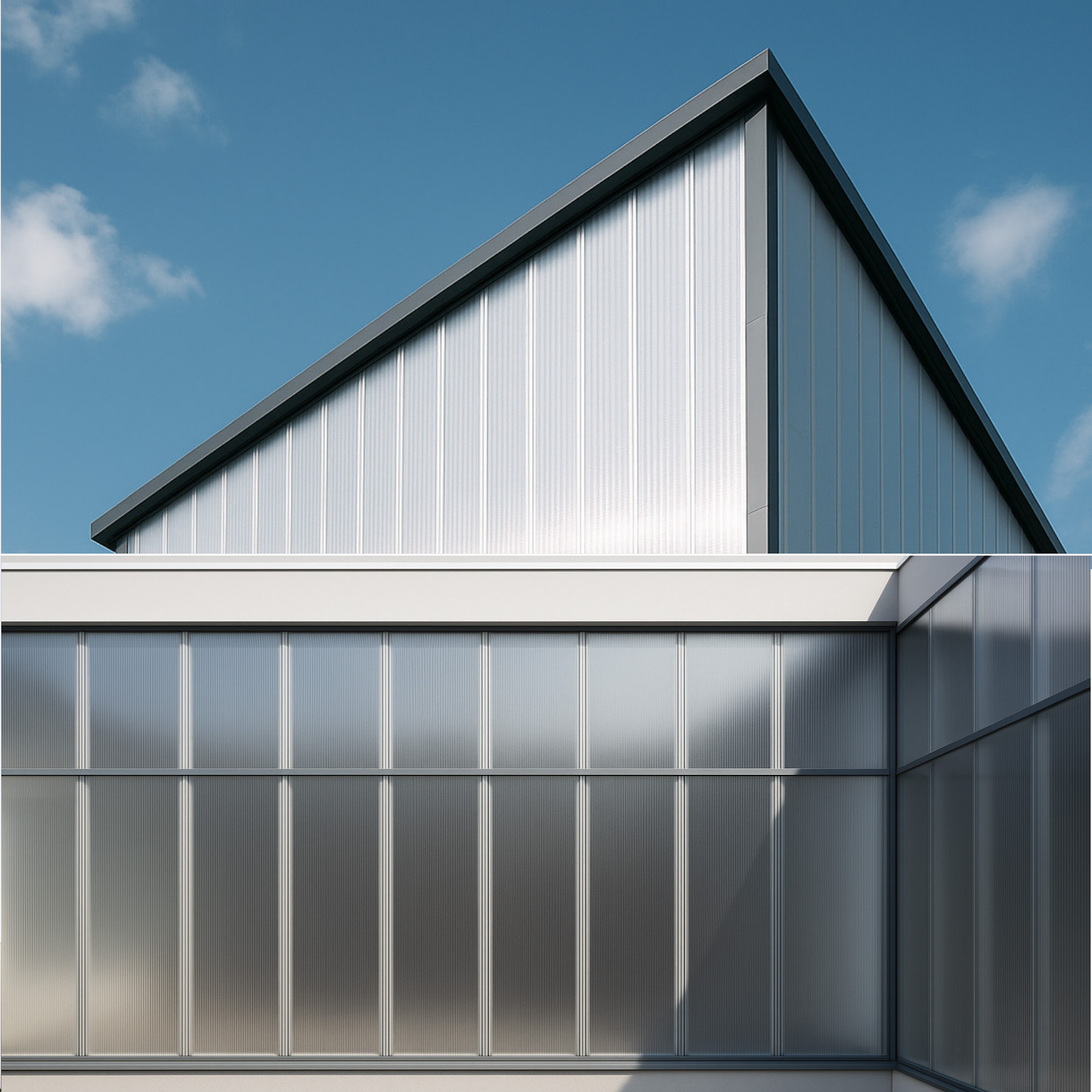

Clients



And more ...

30+

years of excellence

5200+

Projects Delivered

2755+

Clients Served

10+

award wins



With Coxwell, create everyday spaces
that bring light to life.

Connect with us today.

Coxwell Global Pvt. Ltd.
1005, Level 10, JMD Regent
Square, Mehrauli Gurgaon Road,
Gurgaon-122002, Haryana

hello@coxwell.in
www.coxwell.in
+91-9560408739



Scan for more shades

